

INSTALLATION

1. Use the Allen key to loosen screws (1) and (2) on interior side of handle (3). Take apart 2 sides of the handle (3) and (4).
2. Unscrew (5) and (6) connector screw and gaskets (7) from exterior side of handle (4).
3. Place exterior side of handle (4) on the glass, keeping the indexing pin (8) on the top. Reattach the gaskets (7) and connectors (5) and (6).
4. Reattach interior side of handle (3) by securing screws (1) and (2).
5. To determine position of dust proof strike, turn key to locked position and note where pin touches the floor.

ATTENTION

1. Do not let the key on the handle turn to locked position during installation.
2. Please pull and turn the knob slowly and carefully. Keep the handle lock running well.
3. Three keys are included: 2 for the lock and 1 cylinder removal key for the 7-pin, 1-1/4" cylinder.

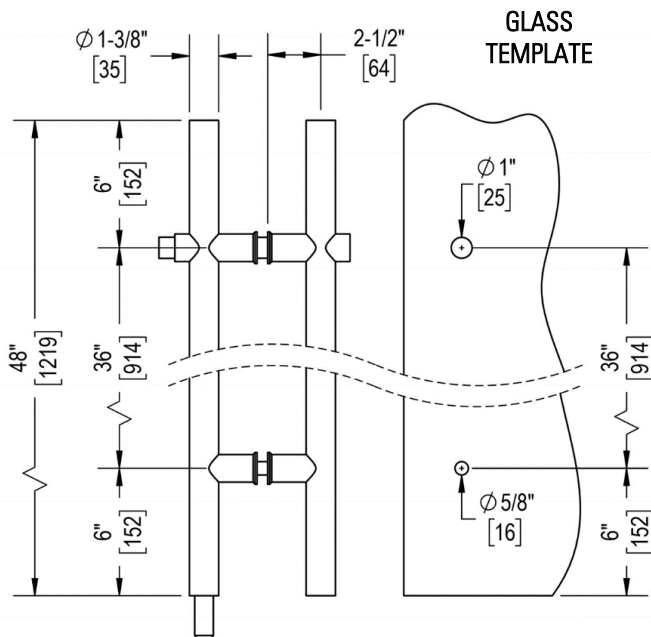
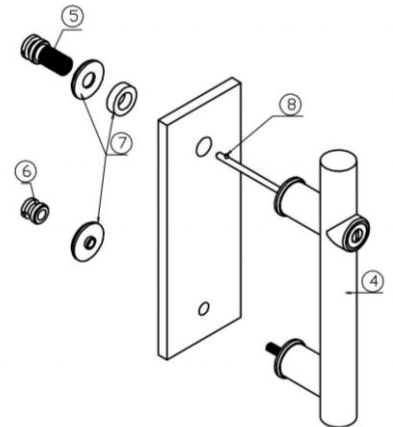
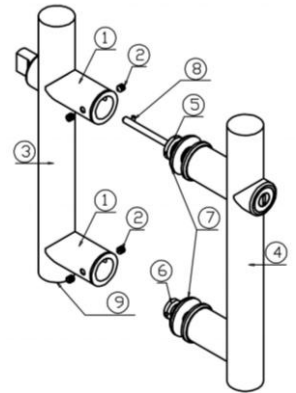

HOLE FOR DUST-PROOF STRIKE

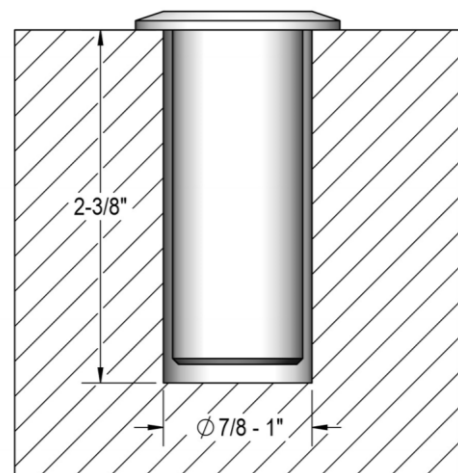

Bohle

portals

Bohle America Inc
10924 Granite Street, Suite 200
Charlotte, NC 28273

T +1 888 838 6006
F +1 704 547 8420
info@bohle-america.com

Description:

Locking Ladder Pull

Article(s):

BA 5213317, BA5213318

Drawn by:

AP

Date:

02.27.23